

Piercing Punch (PCC)

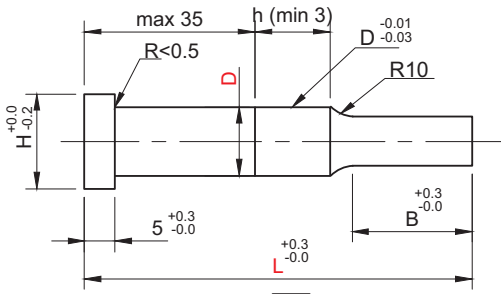

Material :- HCHCr (D)
High Speed Steel (H)
Powder Metallurgy (PM)
Hardness :- 60-62HRC

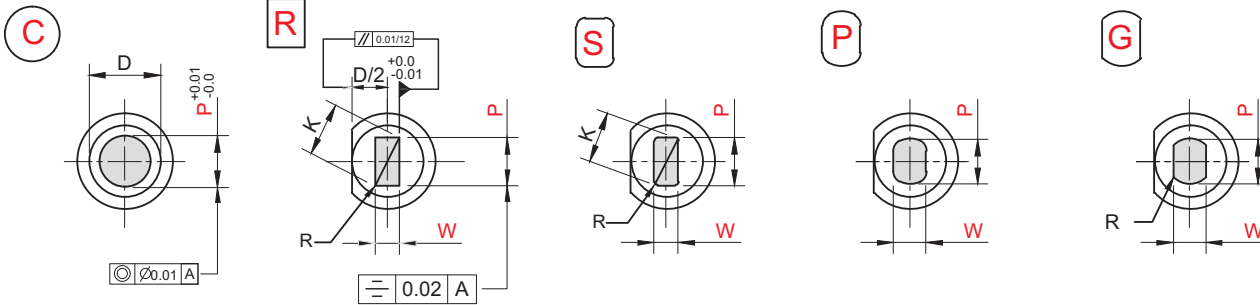

Type	Tip Shape	Tip Length	D	L							0.01 mm increments				B	H	
											C		R S P G				R
											min. P	max	P. K max	P. W min			R
PCC	C	S	3	40	50	60	70	80	90	100	1.00	~2.99			8	5	
			4	40	50	60	70	80	90	100	1.00	~3.99	3.97	1		7	
			5	40	50	60	70	80	90	100	2.00	~4.99	4.97	1.2		8	
			6	40	50	60	70	80	90	100	2.00	~5.99	5.97	1.5		9	
		8	40	50	60	70	80	90	100	3.00	~7.99	7.97	2	13	11		
		10	40	50	60	70	80	90	100	3.00	~9.99	9.97	2.5		13		
		12	70	80	90	100	5.00	~11.99	-		15						
		13	40	50	60	70	80	90	100	6.00	~12.99	12.97	3		16		
		16	40	50	60	70	80	90	100	10.00	~15.99	15.97	4	19	19		
		20	40	50	60	70	80	90	100	13.00	~19.99	19.97	5		23		
		25	40	50	60	70	80	90	100	18.00	~24.99	24.97	6		28		
		3	50	60	70	80	90	100	1.00	~2.99			0.15 < R < W/2		5		
		4	50	60	70	80	90	100	1.00	~3.99	3.97	2		13	7		
		5	50	60	70	80	90	100	2.00	~4.99	4.97	2			8		
		6	50	60	70	80	90	100	2.00	~5.99	5.97	2			9		
		8	50	60	70	80	90	100	3.00	~7.99	7.97	2.5			19	11	
	10	50	60	70	80	90	100	3.00	~9.99	9.97	2.5	13					
	13	50	60	70	80	90	100	6.00	~12.99	12.97	3	16					
	16	60	70	80	90	100	10.00	~15.99	15.97	4	19						
	20	60	70	80	90	100	13.00	~19.99	19.97	5	25	19					
	25	60	70	80	90	100	18.00	~24.99	24.97	6		23					
	3	50	60	70	80	90	100	1.20	~3.99					0.15 < R < W/2	5		
	4	50	60	70	80	90	100	1.20	~2.99	3.97		2			19	7	
	5	60	70	80	90	100	2.00	~4.99	4.97	3.5	25	8					
	6	60	70	80	90	100	2.00	~5.99	5.97	3.5		9					
	8	60	70	80	90	100	3.00	~7.99	7.97	5		30				11	
	10	60	70	80	90	100	3.00	~9.99	9.97	5					13		
	13	60	70	80	90	100	6.00	~12.99	12.97	5	16						
	16	70	80	90	100	10.00	~15.99			19							
	20	70	80	90	100	13.00	~19.99			40	23						
	25	70	80	90	100	18.00	~24.99				28						

Order Type :- Code (Material) X Tip Shape X Tip Length X D X L X P.W
Example :- PCC (D) X P X L X 20 X 100 X 10 X 5